

# Chapter 3 Staples, Bolt, Bow Eye, U-Bolt, Ring, and Strap

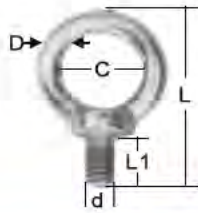

### EYE BOLT AISI 316

ITEM NO.	Size	D	C	d	L1	L	BL/KG	Weight/g
		mm	mm	mm	mm	mm		
<b>004806</b>	6	6	16	M6	14	41	1300	18
<b>004808</b>	8	6.5	20	M8	14	48	1450	30
<b>004810</b>	10	8	23	M10	17	57	2000	58
<b>004812</b>	12	10	30	M12	21	73	2800	105

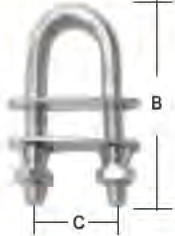

### SECURITY U BOLT WITH INVOLABLE NUTS AISI 316

ITEM NO.	Thread	B mm	C mm	Weight/g
<b>005705</b>	M8	100	40	146
<b>005703</b>	M10	100	40	220
<b>005704</b>	M12	120	47	376



### U BOLTS AISI 316

ITEM NO.	Thread	B mm	L mm	Weight/g
<b>005739</b>	M8	100	40	140
<b>005740</b>	M10	100	40	214
<b>005741</b>	M12	120	47	354



### WATER TIGHT U BOLT AISI 304

White color plastic insert stainless steel plate

ITEM NO.	Thread	Bmm	Cmm	Weight/g
<b>005720</b>	M8	100	35	122
<b>005721</b>	M10	130	50	228
<b>005724</b>	M12	150	65	358

on request AISI 316

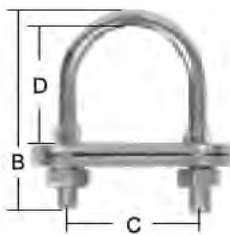

### U BOLTS AISI 304

ITEM NO.	Thread	B mm	C mm	D mm	Weight/g
<b>005706</b>	M5	43	30	25	20
<b>005746</b>	M6	18	33	50	
<b>005742</b>	M6	45	25	40	25
<b>005743</b>	M8	62	45	57	78
<b>005744</b>	M8	88	62	81	106
<b>005745</b>	M8	94	75	87	118

on request AISI 316



### U BOLTS AISI 304

ITEM NO.	Thread	B mm	C mm	D mm	Weight/g
<b>005715</b>	M4	60	30	30	14
<b>005716</b>	M5	80	35	30	28
<b>005708</b>	M6	80	35	30	38
<b>005717</b>	M8	60	35	40	59
<b>005709</b>	M8	80	35	35	71
<b>005710</b>	M8	100	35	40	83
<b>005718</b>	M8	130	35	40	102
<b>005711</b>	M10	90	50	40	140
<b>005713</b>	M10	130	50	40	174
<b>005714</b>	M12	150	65	65	295

on request AISI 316

# Chapter 3

## Staples, Bolt, Bow Eye, U-Bolt, Ring, and Strap

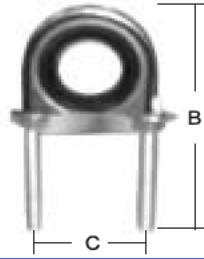

### FAIRLEADS AISI 316

ITEM NO.	Thread	B mm	C mm	Fixing mm	Weight/g
<b>005702</b>	M6	80	35	6	52

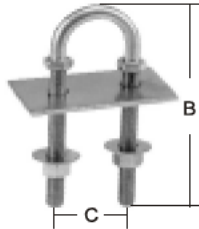

### TRANSOM EYE AISI 316

ITEM NO.	Thread	C	B	Weight/g
<b>005738</b>	5/16"	1-1/2"(38mm)	3"(75mm)	100

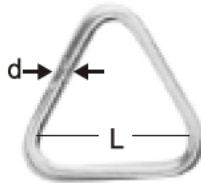

### RING AISI 304

ITEM NO.	L mm	d mm	Weight/g
<b>001240</b>	50	6	30
<b>001270</b>	50	8	73

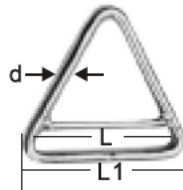

### RING AISI 304

ITEM NO.	L1 mm	L mm	d mm	Weight/g
<b>002560</b>	60	50	6	47

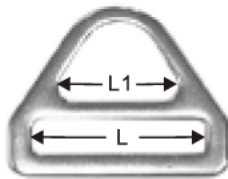

### TRIANGLE SLIDE stamped AISI 304

ITEM NO.	L mm	L1 mm	Thickness mm	Weight/g
<b>002561</b>	48	33	2	18

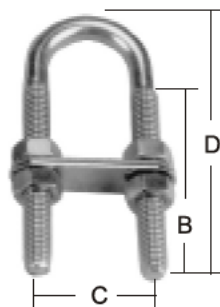

### U BOLTS AISI 304 good for U.S.A. market

ITEM NO.	Thread	B	C	D	Weight/g
<b>005725</b>	1/4"	1-1/2"	1-1/2"	3"	45
<b>005723</b>	1/4"	2"	1-5/8"	3"	38
<b>005726</b>	5/16"	2"	1-1/2"	3"	81
<b>005727</b>	5/16"	2-1/2"	1-1/2"	4"	93
<b>005728</b>	3/8"	2-1/2"	1-1/2"	4"	138
<b>005729</b>	3/8"	3-1/2"	1-1/2"	5"	160
<b>005730</b>	3/8"	5"	1-1/2"	7"	204
<b>005731</b>	1/2"	3"	2"	5"	296
<b>005732</b>	1/2"	3-1/2"	2"	7"	370

on request AISI 316